

Part Number **HSR-790W** Contact Form A Switch Configuration SPST Rev. G

**50W Power Rated Switch**

| Features  | Advantages  |
|---|---|
| <ul style="list-style-type: none"> <li>Hermetically sealed contacts</li> <li>Switch materials are Lead free and RoHS compliant</li> <li>Tungsten contacts in pressurized internal environment</li> <li>Drop Out will not exceed 55% of Pull In</li> </ul> | <ul style="list-style-type: none"> <li>Not ESD sensitive</li> <li>Suitable for high/inductive current loads</li> <li>Extended operations in extreme environments</li> <li>Arc extinguishing atmosphere</li> </ul> |

**Electrical Specifications**

|             |                            |                 |             |
|-------------|----------------------------|-----------------|-------------|
| Power       |                            | Watts - maximum | 50          |
| Voltage     | Switching                  | VDC - maximum   | 1000        |
|             | Breakdown                  | VDC - minimum   | 2500        |
| Current     | Switching                  | Amp - maximum   | 2.5         |
|             | Carry                      | Amp - maximum   | 6.1         |
| Resistance  | Initial Contact Resistance | Ohm - maximum   | 0.10        |
|             | Insulation Resistance      | Ohm - minimum   | 1 E8        |
| Capacitance | Contact                    | pF - typical    | 1.1         |
| Temperature | Operating                  | °C              | 0 to +125   |
|             | Storage                    | °C              | -40 to +200 |

**Magnetic Specifications**

|                 |  |               |         |
|-----------------|--|---------------|---------|
| Pull - In Range |  | Ampere Turns  | 60-100  |
| Test Coil       |  | NARM RS-421-A | Coil IV |

**Physical/Operational Specifications**

|                  |                  |                    |          |
|------------------|------------------|--------------------|----------|
| Capsule Volume   | Excluding Leads  | CC - nominal       | 1.09     |
| Contact Material |                  |                    | Tungsten |
| Operate Time     | Including Bounce | mSeconds - maximum | 3.00     |
| Release Time     | Including Bounce | mSeconds - maximum | 1.60     |

Glass contents under pressure. Eye protection required when handling.

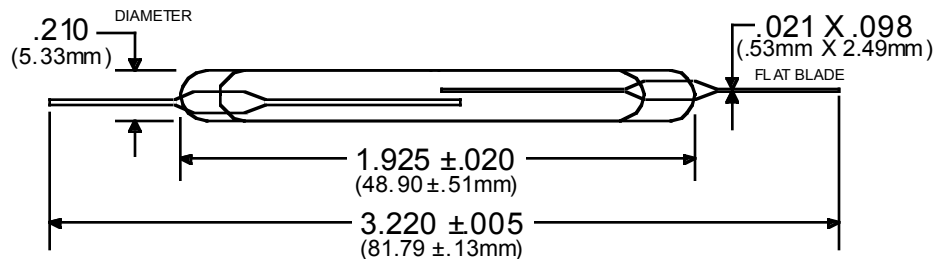

- Notes:
- (1) Specifications are not constant across entire magnetic range.
  - (2) Customer must exercise care in handling, mounting, lead forming, and cutting to prevent damage to glass capsule and/or switch sensitivity.
  - (3) For information or custom configurations about performance, mounting options or packaging, contact our Sales department.
  - (4) Information contained hereon is for informational purposes only and should not be deemed as accurate for a specific application. Consult factory for specific application information and/or latest revision.