

Part Number **HSR-780R** Contact Form A Switch Configuration SPST Rev. D

Large Pressurized Form A Switch for High Voltage & Power Loads

| Features | Advantages |
|---|--|
| <ul style="list-style-type: none"> Hermetically sealed contacts Rhodium contacts in pressurized internal environment Switch materials are Lead free and RoHS compliant | <ul style="list-style-type: none"> Not ESD sensitive High voltage holdoff and switching ability Extended operations in extreme environments Arc extinguishing atmosphere |

Electrical Specifications

| | | | |
|-------------|----------------------------|-----------------|-------------|
| Power | | Watts - maximum | 25 |
| Voltage | Switching | VDC - maximum | 500 |
| | Breakdown | VDC - minimum | 2500 |
| Current | Switching | Amp - maximum | 1.5 |
| | Carry | Amp - maximum | 8.8 |
| Resistance | Initial Contact Resistance | Ohm - maximum | 0.10 |
| | Insulation Resistance | Ohm - minimum | 1 E7 |
| Capacitance | Contact | pF - typical | 0.9 |
| Temperature | Operating | °C | 0 to +125 |
| | Storage | °C | -40 to +200 |

Magnetic Specifications

| | | | |
|-----------------|--|---------------|---------|
| Pull - In Range | | Ampere Turns | 60-100 |
| Test Coil | | NARM RS-421-A | Coil IV |

Physical/Operational Specifications

| | | | |
|------------------|------------------|--------------------|---------|
| Capsule Volume | Excluding Leads | CC - nominal | 1.09 |
| Contact Material | | | Rhodium |
| Operate Time | Including Bounce | mSeconds - maximum | 2.50 |
| Release Time | Including Bounce | mSeconds - maximum | 2.10 |

Glass contents under pressure. Eye protection required when handling.

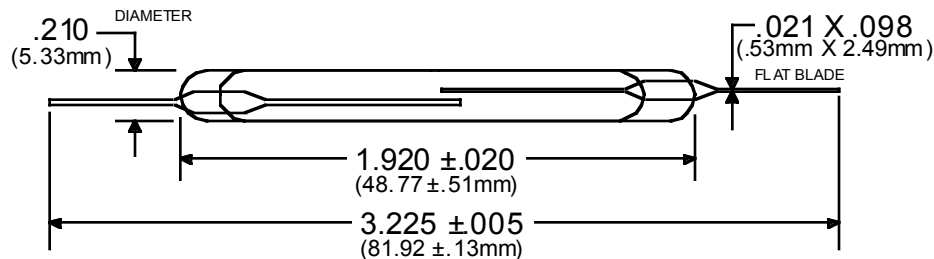

Notes:

- Specifications are not constant across entire magnetic range.
- Customer must exercise care in handling, mounting, lead forming, and cutting to prevent damage to glass capsule and/or switch sensitivity.
- For information or custom configurations about performance, mounting options or packaging, contact our Sales department.
- Information contained hereon is for informational purposes only and should not be deemed as accurate for a specific application. Consult factory for specific application information and/or latest revision.