

Part Number **HSR-V180RF** Contact Form A Switch Configuration SPST Rev. B

High Voltage Holdoff with Radio Frequency Switching

Features	Advantages
<ul style="list-style-type: none"> • Hermetically sealed contacts • Rhodium contacts in vacuum environment • Leaded glass currently exempted from RoHS requirements • Voltage breakdown determined with maximum of 3µA leakage current 	<ul style="list-style-type: none"> • Extended operations in extreme environments • Not ESD sensitive • Q measurement at least 60% of pure Copper wire • Insertion loss < 0.01dB up to 30MHz • RF Isolation > 50dB up to 30MHz

Electrical Specifications

Power		Watts - maximum	25
Voltage	Switching	VAC - maximum	500
	Breakdown	VDC - minimum	5000
Current	Switching	RF Amp - maximum	1.5
	Carry	Amp - maximum	TBD
Resistance	Initial Contact Resistance	Ohm - maximum	0.10
	Insulation Resistance	Ohm - minimum	1 E11
Capacitance	Contact	pF - typical	1.0
Temperature	Operating	°C	-60 to +125
	Storage	°C	-100 to +200

Magnetic Specifications

Pull - In Range		Ampere Turns	60-125
Test Coil		NARM RS-421-A	Coil III

Physical/Operational Specifications

Capsule Volume	Excluding Leads	CC - nominal	1.21
Contact Material			Rhodium
Operate Time	Including Bounce	mSeconds - maximum	3.00
Release Time	Including Bounce	mSeconds - maximum	1.20

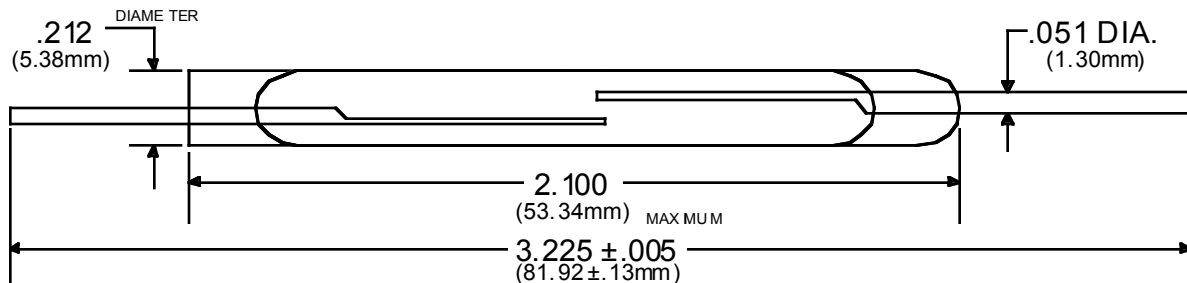

- Notes:
- (1) Specifications are not constant across entire magnetic range.
 - (2) Customer must exercise care in handling, mounting, lead forming, and cutting to prevent damage to glass capsule and/or switch sensitivity.
 - (3) For information or custom configurations about performance, mounting options or packaging, contact our Sales department.
 - (4) Information contained hereon is for informational purposes only and should not be deemed as accurate for a specific application. Consult factory for specific application information and/or latest revision.